

PRODUCT DATA SHEET

Version: 28.03.2017 | 13:37 h

ITEM NO. 37523

Description	Corner profile with pull-off aid
Specification	Fabric dimensions 80 x 120 mm PVC mesh corner brackets with alkali-resistant fibreglass fabric (4 x 4 mm), with sealing edge for plaster thicknesses of 6 mm or more, for heat insulation. For creating precise, perfect vertically and horizontally aligned corners to buildings.
Product Group	Plasterprofiles Thermal insulation systems
Product Category	Corner beads
Plaster Thickness	6 mm
Material	rigid PVC
Colour	white
Package	50 piece
Length in cm	250 cm

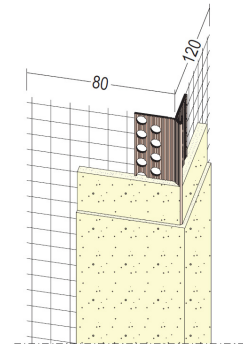

The present product sheet shows the current state of development of our products: with the publication of a new version this is no longer valid. Ensure that you always are using the most recent version of this information. Guarantees and liability upon delivery are defined in our general Terms of Business. Please follow the guidelines for use, fitting and siting. All information is subject to change.

Tender documents, fitting instructions and declarations of performance (where legally required) can all be found on our website. For the sake of the environment, please dispose of correctly!

PROTEKTORWERK
Florenz Maisch GmbH & Co. KG
Postfach 1420, D-76554 Gaggenau
Viktoriastr. 58, D-76571 Gaggenau

Tel.: +49 7225 977 - 0
Fax: +49 7225 9 77 - 111
info@protektor.com
www.protektor.com



PROFILE FÜR
MODERNES
BAUEN